

C U T T I N G T O R C H C T P W L - 0 8 0 1

P A R T S L I S T

If parts are required for replacement, direct order involving description and part number to our sales agent or OTC's office directly.

No.	Parts No.	Description	*1	*2	Remarks
①	H767J00	Shield cup	1	1	
②	H767F01	Tip	1	4	
③	H758G03	Electrode	1	4	
④	H760B00	Torch body	1		Include ① -1 ~ ④ -6
④ -1	H758B03	Insulating cover	(1)		
④ -2	H760F00	Detective pin(1)	(1)		Include ④ -4
④ -3	H760G00	Detective pin(2)	(1)		Include ④ -4
④ -4	H669B02	Detective pin (contact plug)	(2)		
⑤	H758H01	Wrench		1	
⑥	H781E00	Handle set	1		10mm: Include ⑥ -1 ~ ⑥ -4
	H782E00				30mm: Include ⑥ -1 ~ ⑥ -4
	H774E00				20mm: Include ⑥ -1 ~ ⑥ -4
⑦	K2433A00	Torch switch	1	(1)	
⑧	H777B00	Hose cable	1		10mm: Include ⑩, ⑫
⑨	H778B00	Hose cable	1		20mm: Include ⑩, ⑫
⑩	H773B00	Hose cable	1		30mm: Include ⑩, ⑫
⑪	4730-00	Connector (2P plug)	(1)		
⑫		Connector (4P plug)	(1)		W-W00294
★	H767F02	Tip (50A)	1		For cutting of intermediate and sheet
★	H767F03	Tip (30A)	1		For cutting of sheet

Note

*1 : Q'ty

*2 : Spare

★ : Optional parts

Please refer to INSTRUCTION MANUAL for Air plasma cutting power source as to MANUAL and MAINTENANCE.

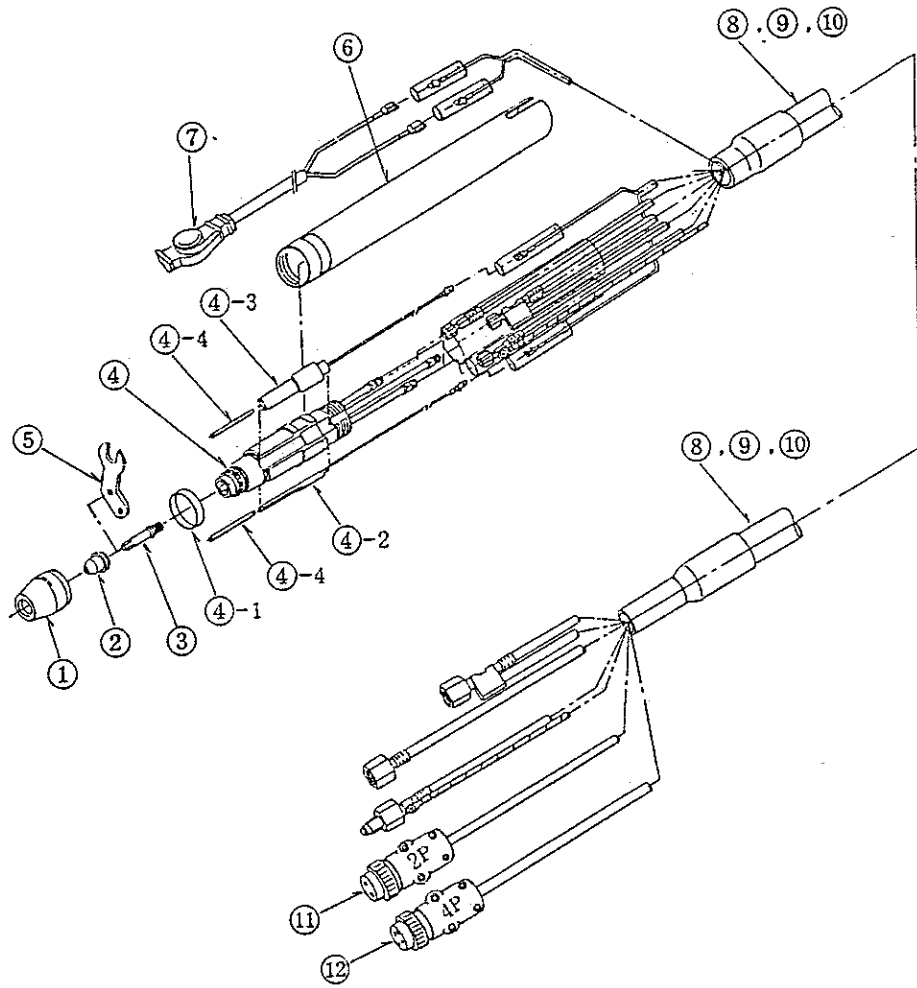

Fig.1 Model External View CTPWL-0801